

## Stress plate HTV-40 RU



### Cross references

DABO® TKR-4.8  
 DABO® TKE-4.8  
 DABO® TKR-4-4.8  
 DABO® VHT-R-4.8  
 DABO® VHT-E-4.8  
 Concrete screw FBS-R  
 Aerated concrete screw FPS-E

### Application range

- > To fix roofing membranes and to fasten pressure-resistant insulation to substructures made of trapezoidal steel profiles, timber, wood-based materials, concrete and aerated concrete
- > For fixings on solid substrate without heat insulation

### Properties

- > Alu-zinc-coated steel

### Note

Compatible with EJOT DABO® screws / with concrete and aerated concrete screws

### Applications

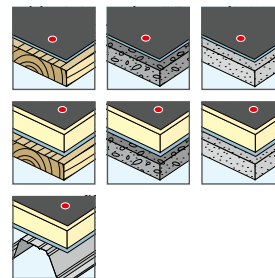

### Certifications



### Product online



Order description	Diameter [mm]	PU [pieces]	Price/100 [EUR]	Article number	EAN
HTV-40 RU	40	500		3020041401	4061245093000

### Compatibility acc. to ETA-07/0013

	SW 8 RT-4.8	SW 8 ET-4.8	TKR-4.8	TKE-4.8	TKR-4-4.8	VHT-R-4.8	VHT-E-4.8	JT2-ST-2-6.0	JT2-ST-2-6.8	JT3-ST-2-6.0	FBS-R-6.3	JBS-R-7.5	FPS-E-8.0	SDF-S-10H-E	SDP-S-10G-E
HTV 40 RU			X	X	X	X	X	X	X	X	X		X		